

5X ϕ .16 THRU ALL
 10-32 UNF THRU ALL
 \checkmark ϕ .21 X 90°, NEAR SIDE

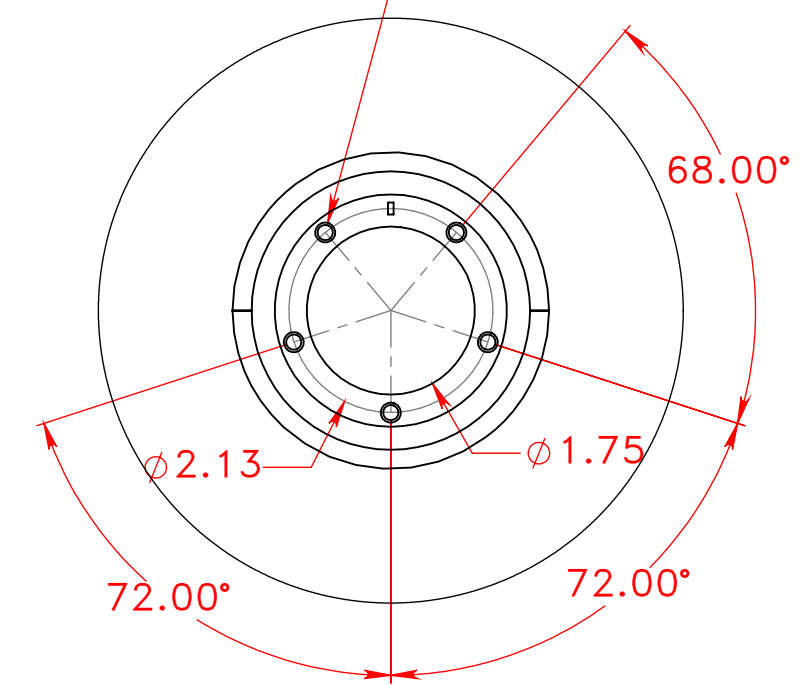

DETAIL A
 SCALE 1 : 2

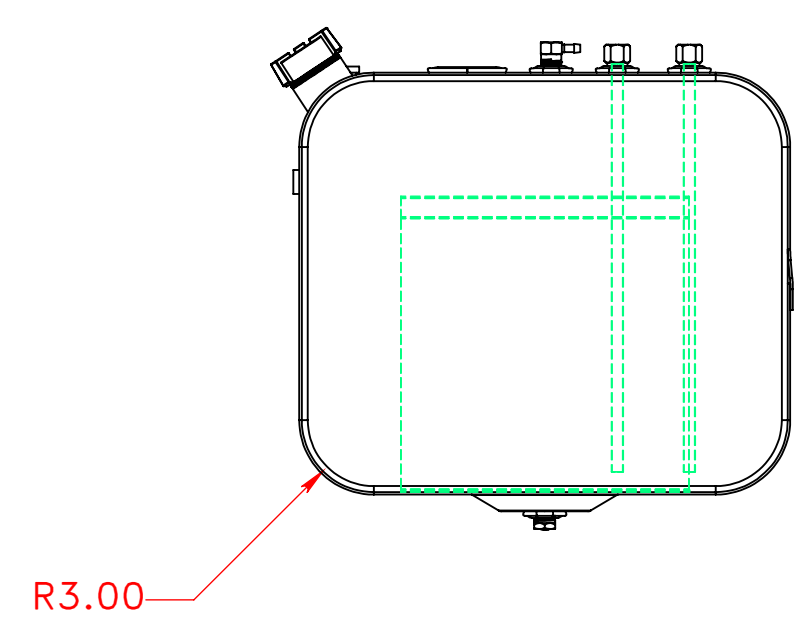
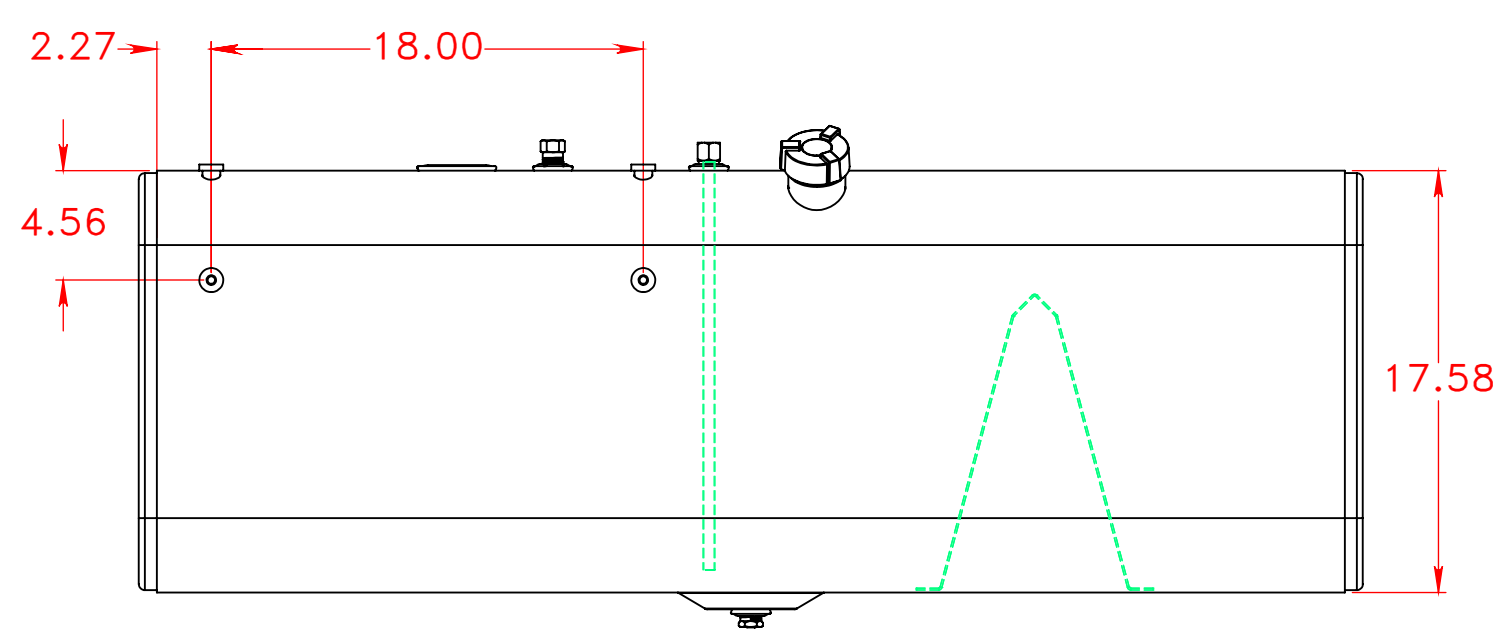
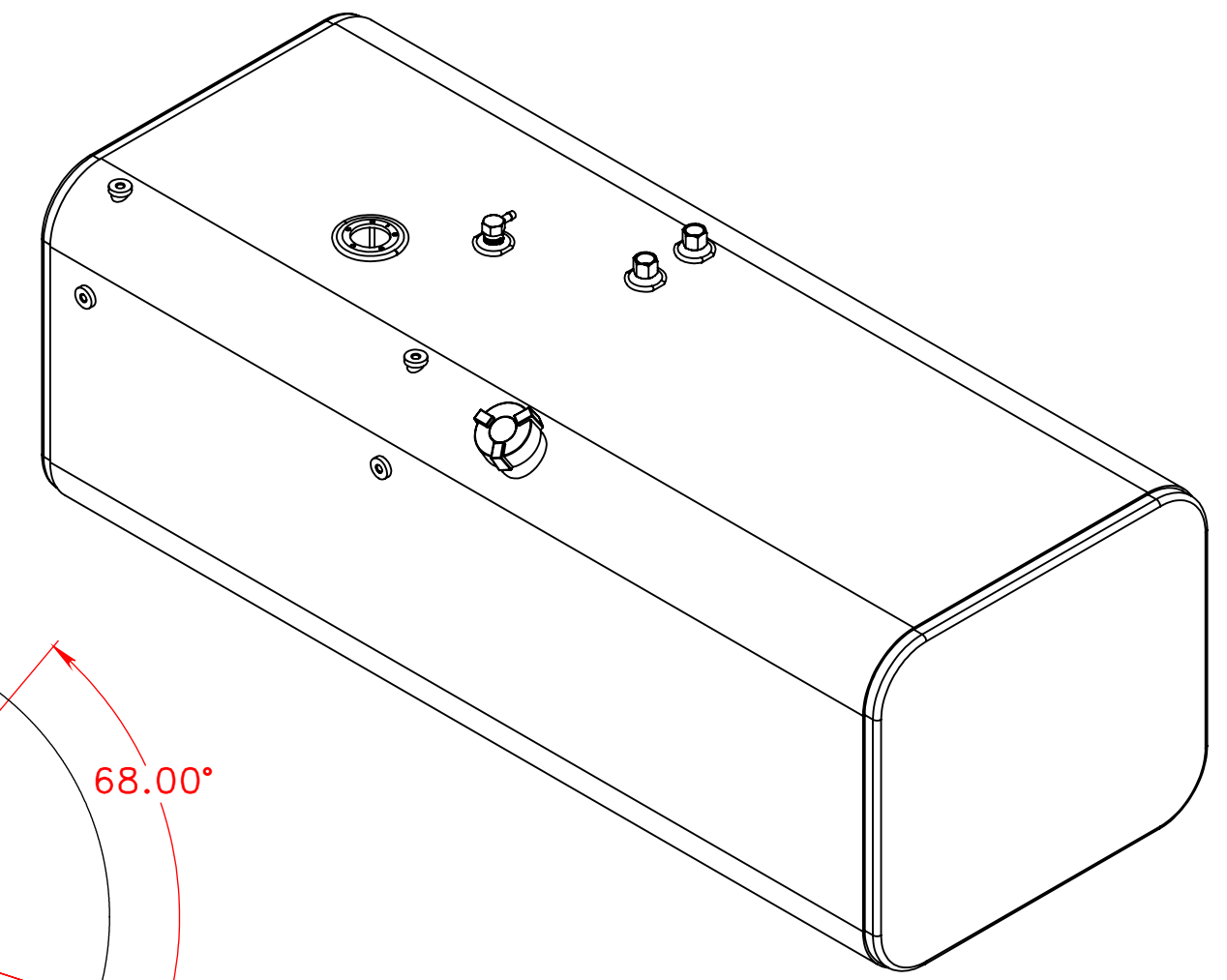

ITEM NO.	PART NUMBER	DESCRIPTION	QTY.
1	126-0806	12 ga HRPO Steel Wrap	1
2	172-0082	Steel Tank Baffle x 12 ga.	1
3	170-0015	17x20 Head	2
4	270-0007	1/2" FNPT Steel weld flange	4
5	275-0002	Steel Float Riser	1
6	227-0001	Step Boss	4
7	326-0001	2" Steel Filler Neck	1
8	458-0100	1/2" NPT Ball Check Drain Plug	1
9	490-0017-Z	1/2" NPT Down Tube	2
10	454-0937	1/2" NPT Ball Check Vent	1
11	452-0998	2" Thermal Relief Fuel Cap	1

NOTES FOR STANDARD CONSTRUCTION:
 ...PRESSURE TESTED @ 5psi PER FMCSA
 ...INTERIOR FREE OF FOREIGN MATTER.
 ...FILLER CAP,DRAIN PLUG,DRAW TUB & VENT PROVIDED.
 ...STEEL CONSTRUCTION 12ga HRPO
 ...STEEL FINISH;
 SEMI-GLOSS BLACK ENAMEL APPLIED.
 ...ALL OPENINGS PLUGGED & THE INTERIOR FOGGED
 WITH ANTI-CORROSION OIL PRIOR TO SHIPPING

UNLESS OTHERWISE SPECIFIED: DIMENSIONS ARE IN INCHES TOLERANCES: FRACTIONAL \pm 1/16 ANGULAR: MACH \pm 1° BEND \pm 1° TWO PLACE DECIMAL \pm .06 THREE PLACE DECIMAL \pm .031	DRAWN	NAME	DATE	PROPOWER MFG. INC. WINDSOR, ONTARIO, CANADA Ph: 519-737-1197 Fax: 519-737-1918 TOLL FREE 1-877-741-2365 Web: metaltanks.com
	CHECKED	A.B	02/11/19	
	ENG APPR.			
	MFG APPR.			
INTERPRET GEOMETRIC TOLERANCING PER: MATERIAL	HRPO STEEL			TITLE: ST-L17-20RFS51-C 75usg DIESEL FUEL TANK
FINISH	DO NOT SCALE DRAWING			SCALE: 1:8 WEIGHT: 140 LBS SHEET 1 OF 1
THIRD ANGLE PROJECTION				DWG. NO. 24629 REV